

STEERING COLUMN

REMOVAL AND INSTALLATION OF STEERING COLUMN

Remove and install the parts as shown.

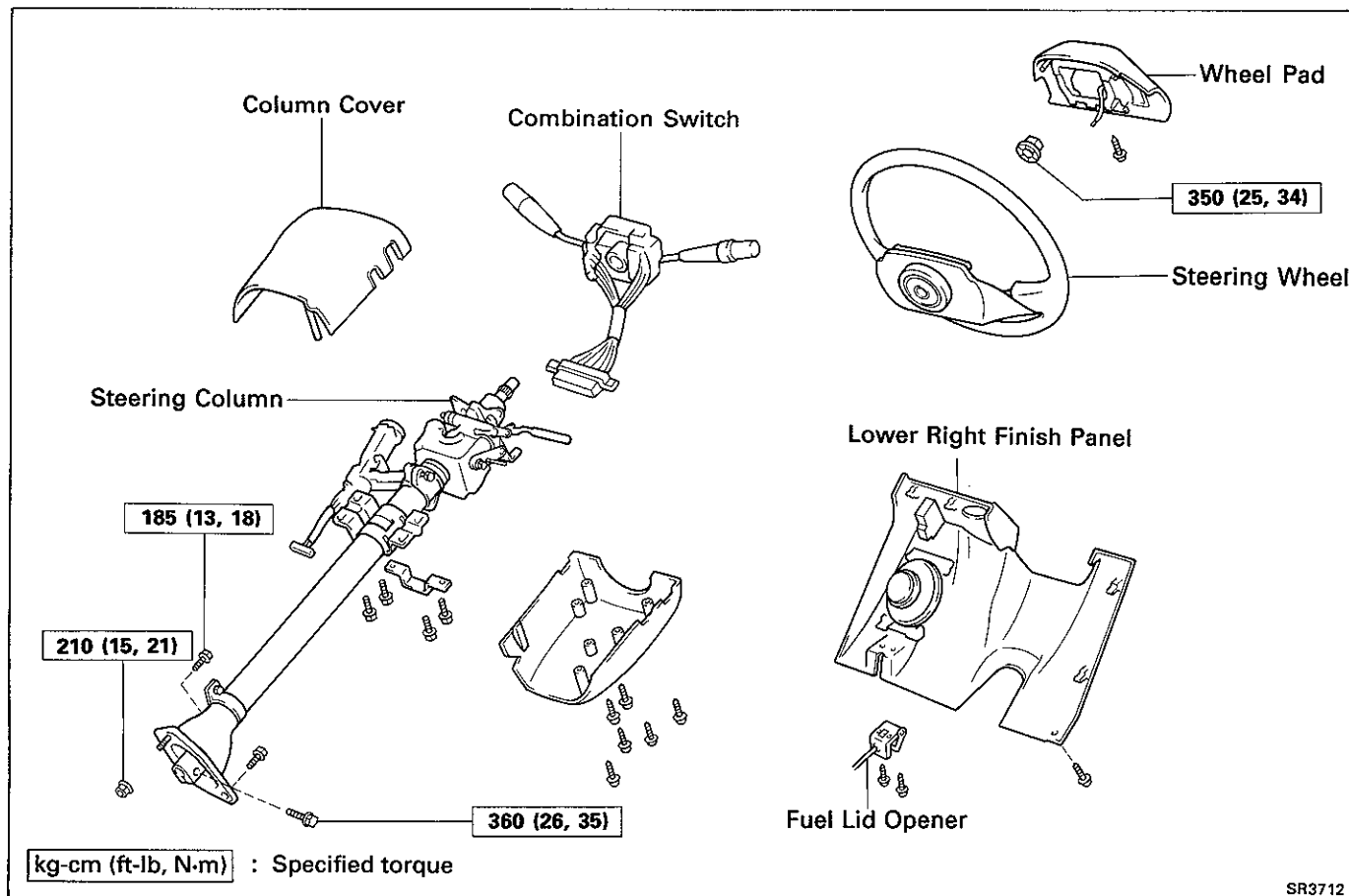

SR3712

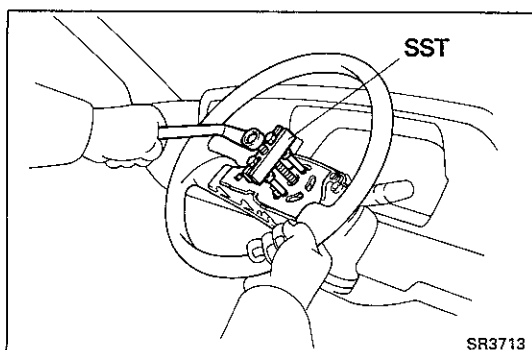

(MAIN POINTS OF REMOVAL)

1. REMOVE STEERING WHEEL

Using SST, remove the steering wheel.

SST 09609-20011

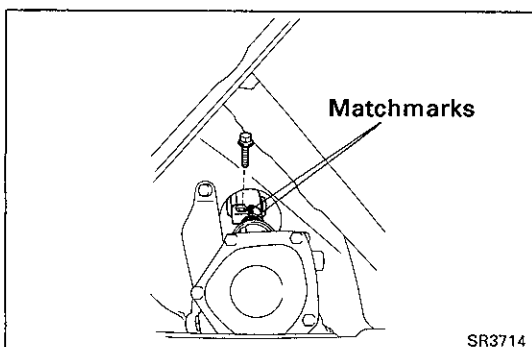

2. DISCONNECT MAIN SHAFT

- Place matchmarks on the bevel gear shaft and main shaft.
- Disconnect the main shaft from the bevel gear shaft.